

ITEM NO.	PART NUMBER	DESCRIPTION	NO. REQ'D
1	C 250-0400-00	PUMP COVER (D250-M2002)	1
2	2-259	"O" RING	1
3	B250-0401-00	UPPER VANE (A250-M2004)	1
4	B250-0402-00	LOWER VANE (A250-M2003)	1
5		3/8 x 1 3/4 DOWEL PIN	1
6		3/8 N.C. x 1 3/4 HEX HEAD BOLT	1
7	C250-0403-00	2 1/2" PUMP BODY (250-M2001)	1
8		1/4-28 GREASE FITTING	1
9	MI-44	STEEL BUSHING	2
10		5/16 N.C. x 1 SOCKETHEAD CAP SCREW	2
11		5/16 SPRING LOCKWASHER	2
12	C250-0404-00	CAM (B250-M2005)	1
13	C250-0405-00	PUMP ROTOR (B250-M2006)	1
14	2-230	"O" RING	1
15		3/8 x 1 1/2 SPRING PIN	3
16		3/8 N.C. WING NUT	4
17		3/8 FLAT WASHER	4
18	B250-0406-00	SWING BOLT (A250-M2007)	4
7A	C250-0403-01	2 1/2" PUMP BODY COMPLETE INCLUDES ITEM NOS 5, 6, 7, 8, 9, 10, 11, 12, 13, 14, 15, 16, 17, 18	

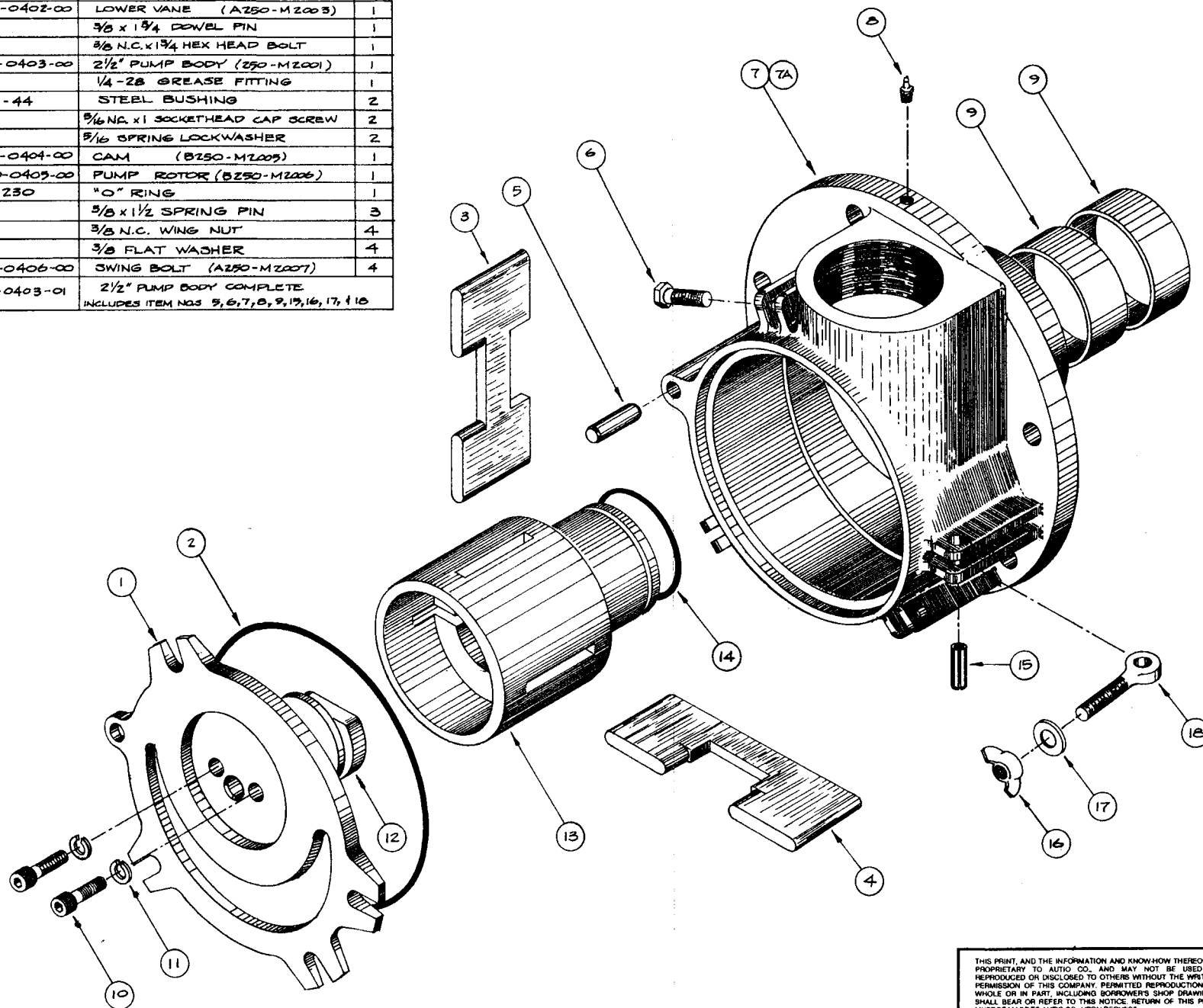

NOTES:

THIS PRINT, AND THE INFORMATION AND KNOW-HOW THEREON, IS PROPRIETARY TO AUTO CO., AND MAY NOT BE USED OR REPRODUCED OR DISCLOSED TO OTHERS WITHOUT THE WRITTEN PERMISSION OF THIS COMPANY. PERMITTED REPRODUCTIONS IN WHOLE OR IN PART, INCLUDING BORROWER'S SHOP DRAWINGS, SHALL BEAR OR REFER TO THIS NOTICE. RETURN OF THIS PRINT MUST BE MADE TO AUTO CO., UPON REQUEST.	MATERIAL:		PER ORDER
	FINISH:		PER ORDER
DWG. SCALE:	DWN. BY:	DATE:	DWG. TITLE:
FRACTIONS: NONE	A. MATSON	11/83	2 1/2" PUMP ASSY
ANGULAR: NONE	ENGR:	DATE:	DWG. NO.:
DECIMAL: XXX			C250-0900-00
DO NOT SCALE DWG	APPROVED BY:	DATE:	REV.
PRINT ISSUE DATE			SH. NO.
UNLESS OTHERWISE NOTED			
NEXT ASSEMBLY:			

**AUTIO** company  
 RT. 4 BOX 480  
 ASTORIA, OREGON 97103 U.S.A.  
 503/458-8191 TWX 910/466-8010



SPECIALIZED EQUIPMENT FOR THE FOOD INDUSTRY

93750 AUTIO LOOP • ASTORIA, OREGON 97103 • USA  
 (503) 458-6191 • (800) 483-8884 • (503) 458-6409

**PARTS LIST**  
**Call 800-483-8884**  
**for price and availability**

**2-1/2" PUMP ASSEMBLY, DWG. C-250-0900-00**

ITEM NO.	PART NUMBER	DESCRIPTION	NBR. REQ.
	250 BLACK	2-1/2" AUTIO PUMP COMPLETE, BLACK	1
	250 HT	2-1/2" AUTIO PUMP COMPLETE, BLACK, HEAT-TREATED	
1	250-0400	PUMP COVER, BLACK -----	1
	250-0400HT	PUMP COVER, BLACK, HEAT-TREATED -----	
2	2-259	COVER O-RING -----	1
3	250-0401-00	UPPER (H) PUMP VANE -----	1
4	250-0402-00	LOWER (C) PUMP VANE -----	1
	250-0401/0402-STD	2-1/2" UPPER/LOWER PUMP VANE SET -----	1 SET
		<i>(Vaness can be ordered individually or in a set.)</i>	
5		3/8 x 1-3/4 DOWEL PIN -----	1
6		3/8 N.C. X 1-1/2 HEX HEAD BOLT -----	1
7	250-0403-00	2-1/2" PUMP BODY, BLACK -----	1
		2-1/2" PUMP BODY, BLACK, HEAT-TREATED -----	1
8		1/4-28 GREASE FITTING -----	1
9	250-MI-44	HARDENED STEEL BUSHINGS ----- (2 PCS)	1 SET
10		5/16 N.C. X 1 HEX HEAD CAPSCREW -----	2
11		5/16 SPRING LOCKWASHER -----	2
12	250-0409-00	CAM, HEART-SHAPED -----	1
	250-0409-01	CAM, HEART SHAPED, UNPLATED -----	
	250-0404-00	CAM, STANDARD (OLD-STYLE) -----	
13	250-0405-00	PUMP ROTOR -----	1
	250-0405-01	PUMP ROTOR, UNPLATED -----	
14	2-230	ROTOR O-RING -----	1
15		3/8 X 1-1/2 SPRING PIN -----	3
16		3/8 N.C. WING NUT -----	4
17		3/8 FLAT WASHER -----	4
18	250-0406-00	SWING BOLT -----	4
	7-A 250-0403-BLACK	2-1/2" PUMP BODY, BLACK, COMPLETE -----	
	7-B 250-0403-HTR	2-1/2" PUMP BODY, BLACK, COMPLETE, HEAT-TREATED -----	
		<i>(Note: 7-A &amp; 7-B includes items #5,6,7,8,9,15,16,17,18)</i>	

NOT PICTURED:

250-6B 801	STUD SLEEVE, (INSIDE MEASUREMENT, 1" SQ X 3" LONG) ----- (ADAPTS 6B 801 PUMP DRIVER STUD TO 2-1/2" PUMP FITS ON SQUARE END OF STUD)
------------	---

COMPLETE PUMP WEIGHT: 65 LBS.

*This equipment must be installed & operated according to all applicable safety regulations.*

Prices subject to change without notice.  
 F.O.B. Plant - Astoria, Oregon U.S.A.  
 Effective: March 1, 2014

Payable in U. S. Funds