

ITEM NO.	PART NUMBER	DESCRIPTION	NO. REQ'D
1	SC250-0400-00	PUMP COVER S.S. (B250-M2002) S.S.	1
2	2-259	"O" RING	1
3	B250-0401-00	UPPER VANE (A250-M2004)	1
4	B250-0402-00	LOWER VANE (A250-M2003)	1
5		3/8 x 1 3/4 DOWEL PIN	1
6		3/8 N.C. x 1 3/4 HEX HEAD BOLT	1
7	SC250-0403-00	2 1/2" PUMP BODY (B250-M2001)	1
8		1/4-28 GREASE FITTING	1
9	MI-44	STEEL BUSHING	2
10		5/16 N.C. x 1 SOCKETHEAD CAP SCREW	2
11		5/16 SPRING LOCKWASHER	2
12	B250-0404-00	CAM (B250-M2005)	1
13	B250-0405-00	PUMP ROTOR (B250-M2006)	1
14	2-230	"O" RING	2
15		3/8 x 1 1/2 SPRING PIN	3
16		3/8 N.C. WING NUT	4
17		3/8 FLAT WASHER	4
18	B250-0406-00	SWING BOLT (A250-M2007)	4
7A	SC250-0403-01	2 1/2" PUMP BODY COMPLETE S.S. INCLUDES ITEM NO. 5, 6, 7, 8, 9, 10, 11, 12	

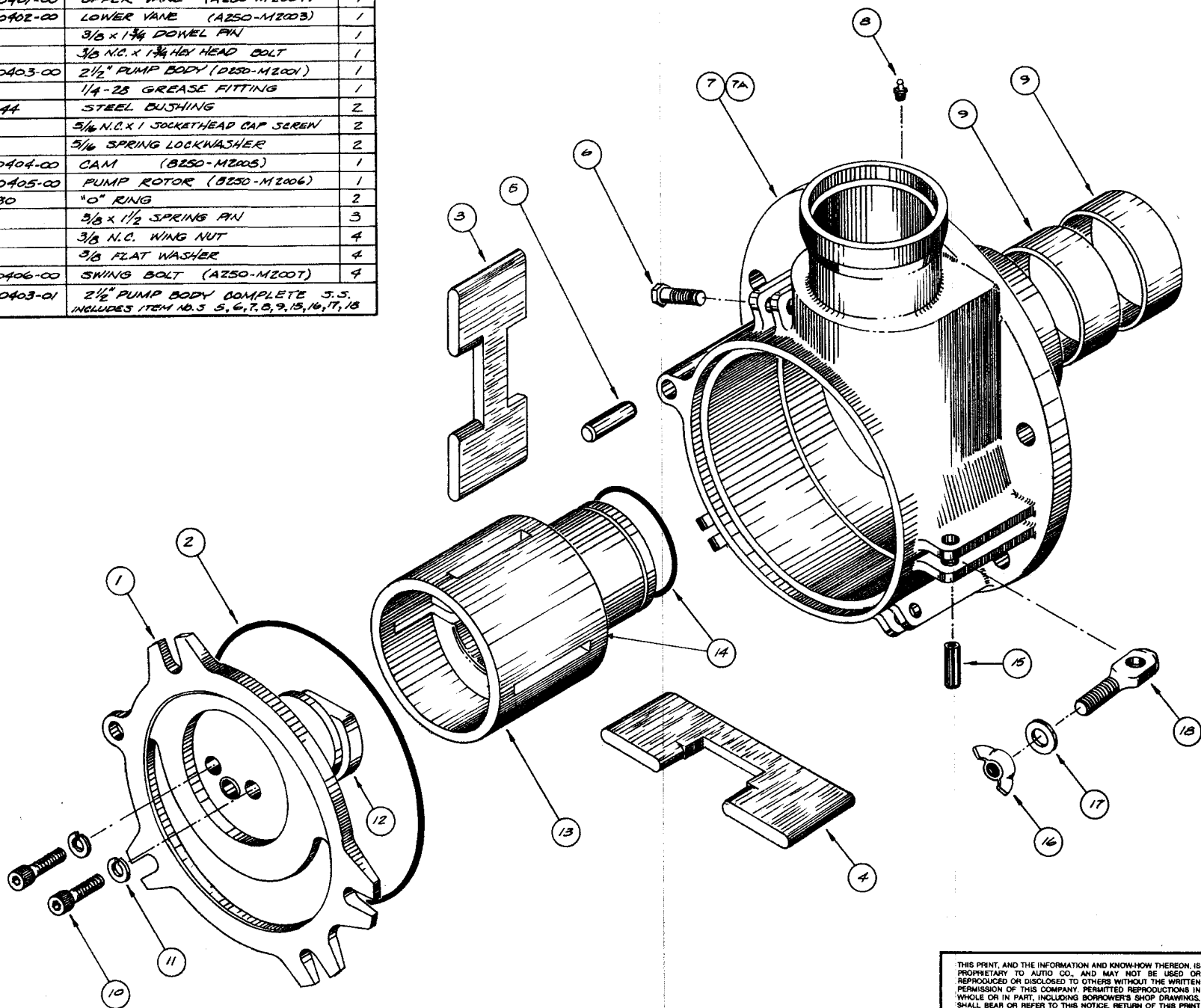

NOTES:

THIS PRINT, AND THE INFORMATION AND KNOW-HOW THEREON, IS PROPRIETARY TO AUTO CO., AND MAY NOT BE USED OR REPRODUCED OR DISCLOSED TO OTHERS WITHOUT THE WRITTEN PERMISSION OF THIS COMPANY. PERMITTED REPRODUCTIONS IN WHOLE OR IN PART, INCLUDING BORROWER'S SHOP DRAWINGS, SHALL BEAR OR REFER TO THIS NOTICE. RETURN OF THIS PRINT MUST BE MADE TO AUTO CO. UPON REQUEST.		MATERIAL: PER ORDER	
DWG. SCALE: UNLESS OTHERWISE NOTED NONE DO NOT SCALE DWG. PRINT ISSUE DATE		FINISH: PER ORDER	
TOLERANCES: FRACTIONS ± ANGULAR ± DECIMAL, XX ± XXX ± UNLESS OTHERWISE NOTED NEXT ASSEMBLY:		DWG. TITLE: 2 1/2" S.S. PUMP ASSY.	
DWN. BY: WEP/MATMAN		DATE: 11/89	
APPROVED BY:		DATE:	
DWG. NO. SC 250-0901-00		REV. SH. NO.	

AUTO company
 FT. 4 BOX 480
 ASTORIA, OREGON 97103 U.S.A.
 503/458-6191 TWX 910/466-9010



SPECIALIZED EQUIPMENT FOR THE FOOD INDUSTRY

93750 AUTIO LOOP • ASTORIA, OREGON 97103 • USA
 (503) 458-6191 • (800) 483-8884 • (503) 458-6409

PARTS LIST
Call 800-483-8884
for price and availability

2-1/2" STAINLESS STEEL PUMP ASSEMBLY, DWG. #C-250-0901-00

ITEM NO.	PART NUMBER	DESCRIPTION	NBR. REQ.
	250 SS	2-1/2" STAINLESS STEEL AUTIO PUMP, COMPLETE -----	
	250 SS1	2-1/2" STAINLESS STEEL AUTIO PUMP, COMPLETE WITH DOUBLE O-RING GROOVE, COVER INSERT RING, AND DELRIN LINER. -----	
1	SC250-0400	PUMP COVER, STAINLESS STEEL -----	1
2	2-259	COVER O-RING -----	1
3	250-0401-00	UPPER (H) PUMP VANE -----	1
4	250-0402-00	LOWER (C) PUMP VANE -----	1
	250-0401/0402-STD	2-1/2" UPPER/LOWER PUMP VANE SET ----- <i>(Vaness can be ordered individually or in a set.)</i>	1 SET
5		3/8 X 1-3/4 DOWEL PIN -----	1
6		3/8 N.C. X 1-3/4 HEX HEAD BOLT -----	1
7	SC250-0403-00	STAINLESS STEEL PUMP BODY -----	
8		1/4-28 GREASE FITTING -----	1
9	250-MI-44	HARDENED STEEL BUSHINGS ----- (2 PCS) -----	1 SET
10		5/16 N.C. X 1 HEX HEAD CAPSCREW -----	2
11		5/16 SPRING LOCKWASHER -----	2
12	250-0409-00	CAM, HEART-SHAPED -----	1
	250-0404-00	CAM, STANDARD (OLD STYLE) -----	
13	250-0405-00	PUMP ROTOR -----	1
14	2-230	ROTOR O-RING -----	1
15		3/8 X 1-1/2 STAINLESS STEEL SPRING PIN -----	3
16		3/8 N.C. STAINLESS STEEL WING NUT -----	4
17		3/8 STAINLESS STEEL FLAT WASHER -----	4
18	SC250-0406-00	SWING BOLT, STAINLESS STEEL -----	4
7-A	SC250-0403	STAINLESS STEEL PUMP BODY COMPLETE ----- <i>(Includes Items #5,6,7,8,9,15,16,17,18)</i>	
	SC250-0403 B	STAINLESS STEEL PUMP BODY, BORED FOR LINER ----- <i>(Includes Items #5,6,7,8,9,15,16,17,18)</i>	

AVAILABLE / NOT PICTURED:

250-0408-00	2-1/2" DELRIN LINER -----
250-0410-00	2-1/2" COVER INSERT RING -----
250-0413-00	2-1/2" TOOL STEEL LINER -----
SC250-0400-1	2-1/2" S/S COVER W/ COVER INSERT RING INSTALLED -----
250-0401/0402-UNPL	2-1/2" UPPER/LOWER VANES, UNPLATED -----
250-0405-01	2-1/2" ROTOR, UNPLATED

COMPLETE PUMP WEIGHT: 65 LBS.

This equipment must be installed & operated according to all applicable safety regulations.

Prices subject to change without notice.
 F.O.B. Plant - Astoria, Oregon U.S.A.
 Effective: March 1, 2014

Payable in U. S. Funds